



PRODUCTION CATALOG



CÔNG TY TNHH THƯƠNG MẠI VÀ ĐẦU TƯ XÂY DỰNG BẢO HÀ

Mobile: 0977 931 525

Website: baohatic.vn

GIỚI THIỆU CÔNG TY

Công ty TNHH Thương Mại Và Đầu Tư Xây Dựng Bảo Hà

Được thành lập từ 2015, Công ty Bảo Hà là một trong những công ty hàng đầu chuyên sản xuất và cung ứng các sản phẩm vật tư dùng cho hệ thống cấp thoát nước, phòng cháy chữa cháy. Các sản phẩm của Công ty Bảo Hà cung ứng đều được sản xuất trên dây truyền hiện đại theo tiêu chuẩn quốc tế với chất lượng cao, bền, mẫu mã đẹp phù hợp với tất cả các công trình dân dụng và công nghiệp và hệ thống tưới công nghệ cao, hệ thống thủy lợi... Sản phẩm nhập khẩu chính hãng, đầy đủ chứng chỉ CO - CQ, bảo hành chính hãng.

Các sản phẩm nổi bật :

- Van gang mặt bích (Van cổng, Van cửa, Van 1 chiều...)
- Van nhựa UPVC (Van bướm UPVC, Van bi UPVC, Van 1 chiều UPVC, Rọ bơm UPVC...)
- Van nhựa PPH (Van bi rắc co PPH, Van bi mặt bích PPH, Bích PPH...)
- Van bi rắc co PPR, Van bi mặt bích PPR, Mặt bích PPR
- Phụ kiện HDPE hàn đối đầu PN10 - PN12.5 - PN16 (HDPE Butt Fusion)
- Phụ kiện HDPE hàn điện trở (HDPE Electro Fusion)
- Phụ kiện HDPE hàn nối trong (HDPE Socket Fusion)
- Phụ kiện HDPE siết gioăng (PP Compression Fittings)
- Phụ kiện UPVC nối gioăng, Phụ kiện UPVC dán keo
- Mối nối mềm BE, Mối nối mềm EE, Bù Machon FF, Bù Manchon BF
- Tê gang EEB, Tê gang EEE, Tê gang BBB, Cút gang EE, Cút gang BB
- Van cổng inox, van 1 chiều inox, van bướm inox, bích inox
- Van giảm áp, Van an toàn chống va, Van báo báo động, Van xả tràn ngập
- Đồng hồ đo lưu lượng nước, đồng hồ áp lực
- Mối nối chuyển bậc, mối nối chuyển nhựa thép, mối nối chuyển vật liệu
- Đai khởi thủy mặt bích, phụ kiện ống thép, phụ kiện ống inox
- Ống và phụ kiện nhựa HDPE, UPVC, PPR, Gang, Thép, Inox...
- Máy hàn ống nhựa (HDPE, PPR)

Với phương châm luôn mang đến cho Quý khách hàng những sản phẩm chất lượng tốt nhất với giá thành cạnh tranh. Công ty chúng tôi chân thành cảm ơn và mong nhận được sự ủng hộ từ Quý khách hàng. Xin chân thành cảm ơn.

TRUE UNION BALL VALVE (UPVC CPVC PPH)

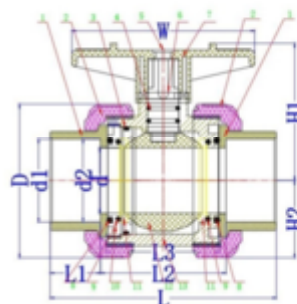

SIZE: 1/2" ~ 4"

JOINT END: SOCKET (ANSI / DIN / JIS)

THREADED (PT/NPT/BSPP)

WORKING PRESSURE: 150PSI

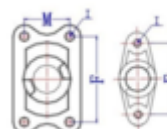

No.	Part name	Raw material	QTY	Unit
3/4/8/9	O-ring	EPDM / VITON	7	PCS
1	Socket end	UPVC / CPVC / PPH	2	PCS
2	Cap	UPVC / CPVC / PPH	2	PCS
5	Logo	ABS	1	PCS
6	Banll shaft	UPVC / CPVC / PPH	1	PCS
7	Handle	ABS	1	PCS
10	Lining	UPVC / CPVC / PPH	1	PCS
11	Anti-leak ring	PTFE	2	PCS
12	Ball	UPVC / CPVC / PPH	1	PCS
13	Body	UPVC / CPVC / PPH	1	PCS

UNIT: MM

SIZE	d	d1				d2			
		ANSI	DIN	JIS	PPH	ANSI	DIN	JIS	PPH
1/2" (15)	15	21.4	20.3	22.3	19.3	21.3	20.1	21.9	19
3/4" (20)	20	26.7	25.3	26.3	24.1	26.6	25.1	25.9	23.8
1" (25)	25	33.5	32.3	32.3	31	33.3	32.1	31.9	30.7
1.1/4" (32)	32	42.3	40.3	38.5	39	42.1	40.1	37.9	38.6
1.1/2" (40)	40	48.4	50.3	48.5	49	48.2	50.1	47.8	48.6
2" (50)	50	60.5	63.3	60.6	61.9	60.2	63.1	59.8	61.4
2.1/2" (65)	63	73.3	75.3	76.6	73.6	72.9	75.1	75.9	72.3
3" (80)	75	89.3	90.3	89.6	88.9	88.7	90.1	88.9	86.9
4" (100)	90	114.6	110.4	114.7	108	114.1	110.1	113.9	106.4

UNIT: MM

SIZE	D	L	L1	L2	L3	W	H1	H2	F	M	I
1/2" (15)	54	108	23	62	52	84	52	27.5	31	-	M6
3/4" (20)	63	115	26	63	54	90	59	32	33	-	M6
1" (25)	73.5	130	29	72	62	106	67.5	37.3	40	-	M6
1.1/4" (32)	84.5	145	33	79.5	70	116	77.5	42.8	52	-	M8
1.1/2" (40)	98	161	35.5	90	79.5	128	90	50	52	-	M8
2" (50)	118	175	38.5	98	85	140	106	60	70	-	M8
2.1/2" (65)	150	276	64.5	147	133	198	136.5	76.5	84	45	M10
3" (80)	169	303	70	163	146	218	150	86	84	45	M10
4" (100)	190	353	84	185	160	235	166	95	121	45	M12

ELECTRIC ACTUATOR DOUBLE UNION BALL VALVE (UPVC CPVC PPH)

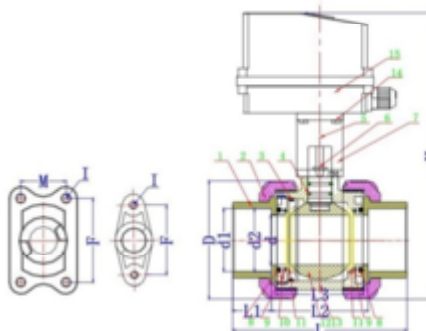

SIZE: 1/2" ~ 4"

JOINT END: SOCKET (ANSI / DIN / JIS)

THREADED (PT/NPT/BSPF)

WORKING PRESSURE: 150PSI

No.	Part name	Raw material	QTY	Unit
3/4/8/9	O-ring	EPDM / VITON	7	PCS
1	Socket end	UPVC / CPVC / PPH	2	PCS
2	Cap	UPVC / CPVC / PPH	2	PCS
5	Logo	ABS	1	PCS
6	Banll shaft	UPVC / CPVC / PPH	1	PCS
7	Handle	ABS	1	PCS
10	Lining	UPVC / CPVC / PPH	1	PCS
11	Anti-leak ring	PTFE	2	PCS
12	Ball	UPVC / CPVC / PPH	1	PCS
13	Body	UPVC / CPVC / PPH	1	PCS

UNIT: MM

SIZE	d	d1				d2			
		ANSI	DIN	JIS	PPH	ANSI	DIN	JIS	PPH
1/2" (15)	15	21.4	20.3	22.3	19.3	21.3	20.1	21.9	19
3/4" (20)	20	26.7	25.3	26.3	24.1	26.6	25.1	25.9	23.8
1" (25)	25	33.5	32.3	32.3	31	33.3	32.1	31.9	30.7
1.1/4" (32)	32	42.3	40.3	38.5	39	42.1	40.1	37.9	38.6
1.1/2" (40)	40	48.4	50.3	48.5	49	48.2	50.1	47.8	48.6
2" (50)	50	60.5	63.3	60.6	61.9	60.2	63.1	59.8	61.4
2.1/2" (65)	63	73.3	75.3	76.6	73.6	72.9	75.1	75.9	72.3
3" (80)	75	89.3	90.3	89.6	88.9	88.7	90.1	88.9	86.9
4" (100)	90	114.6	110.4	114.7	108	114.1	110.1	113.9	106.4

UNIT: MM

SIZE	D	L	L1	L2	L3	W	H1	H2	F	M	I
1/2" (15)	54	108	23	62	52	84	52	27.5	31	-	M6
3/4" (20)	63	115	26	63	54	90	59	32	33	-	M6
1" (25)	73.5	130	29	72	62	106	67.5	37.3	40	-	M6
1.1/4" (32)	84.5	145	33	79.5	70	116	77.5	42.8	52	-	M8
1.1/2" (40)	98	161	35.5	90	79.5	128	90	50	52	-	M8
2" (50)	118	175	38.5	98	85	140	106	60	70	-	M8
2.1/2" (65)	150	276	64.5	147	133	198	136.5	76.5	84	45	M10
3" (80)	169	303	70	163	146	218	150	86	84	45	M10
4" (100)	190	353	84	185	160	235	166	95	121	45	M12

PNEUMATIC ACTUATOR DOUBLE UNION BALL VALVE (UPVC CPVC PPH)

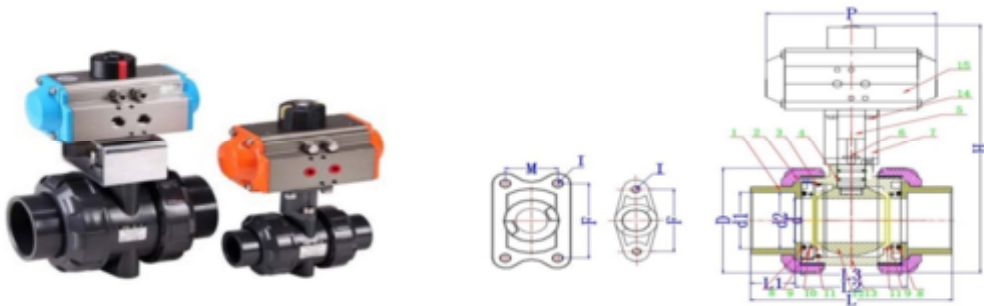

SIZE: 1/2" ~ 4"

JOINT END: SOCKET (ANSI / DIN / JIS / CNS)

THREADED (PT/NPT/BSPF)

WORKING PRESSURE: 150PSI

No.	Part name	Raw material	QTY	Unit
3/4/8/9	O-ring	EPDM / VITON	7	PCS
1	Socket end	UPVC / CPVC / PPH	2	PCS
2	Cap	UPVC / CPVC / PPH	2	PCS
5	Logo	ABS	1	PCS
6	Banll shaft	UPVC / CPVC / PPH	1	PCS
7	Handle	ABS	1	PCS
10	Lining	UPVC / CPVC / PPH	1	PCS
11	Anti-leak ring	PTFE	2	PCS
12	Ball	UPVC / CPVC / PPH	1	PCS
13	Body	UPVC / CPVC / PPH	1	PCS

UNIT: MM

SIZE	d	d1				d2			
		ANSI	DIN	JIS	PPH	ANSI	DIN	JIS	PPH
1/2" (15)	15	21.4	20.3	22.3	19.3	21.3	20.1	21.9	19
3/4" (20)	20	26.7	25.3	26.3	24.1	26.6	25.1	25.9	23.8
1" (25)	25	33.5	32.3	32.3	31	33.3	32.1	31.9	30.7
1.1/4" (32)	32	42.3	40.3	38.5	39	42.1	40.1	37.9	38.6
1.1/2" (40)	40	48.4	50.3	48.5	49	48.2	50.1	47.8	48.6
2" (50)	50	60.5	63.3	60.6	61.9	60.2	63.1	59.8	61.4
2.1/2" (65)	63	73.3	75.3	76.6	73.6	72.9	75.1	75.9	72.3
3" (80)	75	89.3	90.3	89.6	88.9	88.7	90.1	88.9	86.9
4" (100)	90	114.6	110.4	114.7	108	114.1	110.1	113.9	106.4

UNIT: MM

SIZE	D	L	L1	L2	L3	W	H1	H2	F	M	I
1/2" (15)	54	108	23	62	52	84	52	27.5	31	-	M6
3/4" (20)	63	115	26	63	54	90	59	32	33	-	M6
1" (25)	73.5	130	29	72	62	106	67.5	37.3	40	-	M6
1.1/4" (32)	84.5	145	33	79.5	70	116	77.5	42.8	52	-	M8
1.1/2" (40)	98	161	35.5	90	79.5	128	90	50	52	-	M8
2" (50)	118	175	38.5	98	85	140	106	60	70	-	M8
2.1/2" (65)	150	276	64.5	147	133	198	136.5	76.5	84	45	M10
3" (80)	169	303	70	163	146	218	150	86	84	45	M10
4" (100)	190	353	84	185	160	235	166	95	121	45	M12

FLANGE BALL VALVE (UPVC CPVC PPH)

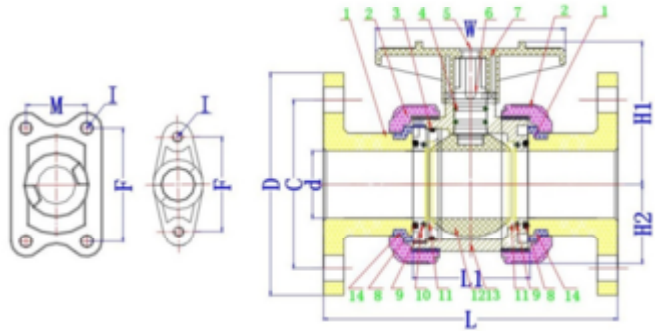

SIZE: 1/2" ~ 4"

FLANGE: (ANSI, DIN, JIS)

WORKING PRESSURE: 150PSI

No.	Part name	Raw material	QTY	Unit
3/4/8/9	O-ring	EPDM / VITON	7	PCS
1	Socket end	UPVC / CPVC / PPH	2	PCS
2	Cap	UPVC / CPVC / PPH	2	PCS
5	Logo	ABS	1	PCS
6	Ball shaft	UPVC / CPVC / PPH	1	PCS
7	Handle	ABS	1	PCS
10	Lining	UPVC / CPVC / PPH	1	PCS
11	Anti-leak ring	PTFE	2	PCS
12	Ball	UPVC / CPVC / PPH	1	PCS
13	Body	UPVC / CPVC / PPH	1	PCS
14	Flange buckle	UPVC / CPVC / PPH	2	PCS

UNIT: MM

SIZE	d	d1			D	L	L1	W	H1	H2	F	M	I	N-Ø _e
		ANSI	JIS	DIN										
1/2" (15)	15	60.5	70	65	95	134	52	84	52	27.5	31	-	M6	4-15
3/4" (20)	20	70	75	75	105	144	54	90	59	32	33	-	M6	4-15
1" (25)	25	79.2	90	85	125	160	62	106	67.5	37.3	40	-	M6	4-19
1.1/4" (32)	32	89	100	100	140	178	70	116	77.5	42.8	52	-	M8	4-19
1.1/2" (40)	40	98	105	110	150	195	79.5	128	90	50	52	-	M8	4-19
2" (50)	50	121	120	125	165	215	85	140	106	60	70	-	M8	4-19
2.1/2" (65)	63	140	140	145	182	320	133	198	136.5	76.5	84	45	M10	4-19
3" (80)	75	150	152	160	200	350	146	218	150	86	84	45	M10	8-19
4" (100)	90	190	175	180	228	395	160	235	166	95	121	45	M12	8-19

COMPACT BALL VALVE (UPVC CPVC)

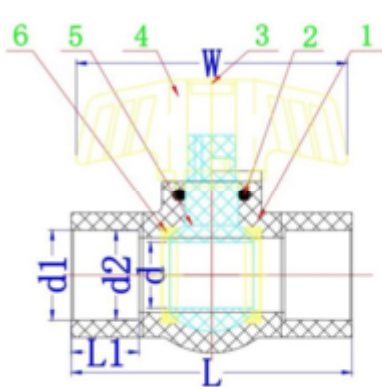

SIZE: 1/2’’ – 8’’

JOINT END: SOCKET (ANSI / DIN / JIS)

: THREADED (PT / NPT / BSPF)

WORKING PRESSURE: 150 PSI

No.	Part name	Raw material	QTY	Unit
1	Body	UPVC / CPVC	1	PCS
2	O-ring	NRB	1	PCS
3	Logo	ABS	1	PCS
4	Handle	ABS	1	PCS
5	Ball	UPVC / CPVC	1	PCS
6	Anti-leak ring	TPV	2	PCS

UNIT: MM

SIZE	d	d1			d2			L	L1	W
		ANSI	DIN	JIS	ANSI	DIN	JIS			
1/2" (15)	15	21.4	20.3	22.3	21.3	20.1	21.9	78	22	70
3/4" (20)	20	26.7	25.3	26.3	26.6	25.1	25.9	90	25	79
1" (25)	25	33.5	32.3	32.3	33.3	32.1	31.9	105	30	99
1.1/4" (32)	32	42.3	40.3	38.5	42.1	40.1	37.9	122	32	112
1.1/2" (40)	40	48.4	50.3	48.5	48.2	50.1	47.8	130	34	112
2" (50)	50	60.5	63.3	60.6	60.2	63.1	59.8	148	38	138
2.1/2" (65)	63	73.3	75.3	76.6	72.9	75.1	75.9	179	46	205
3" (80)	75	89.3	90.3	89.6	88.7	90.1	88.9	205	50	205
4" (100)	90	114.6	110.4	114.7	114.1	110.1	113.9	253	60	235
5" (125)	120	141.5	140.6	141.5	141.3	139.9	140.5	295	70	280
6" (150)	150	168.8	160.5	166.8	168.5	160.2	168.2	350	90	280
8" (200)	190	219.8	200.6	217	219.5	200.2	216	450	120	320

BALL VALVE (FLANGED) UPVC CPVC PPH PVDF FRPP

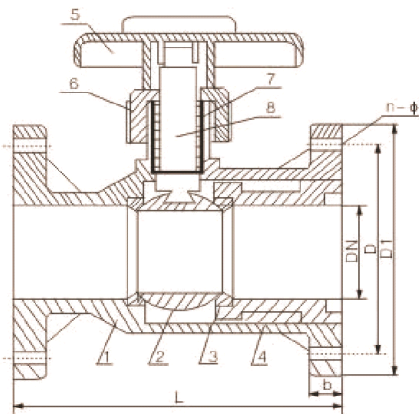
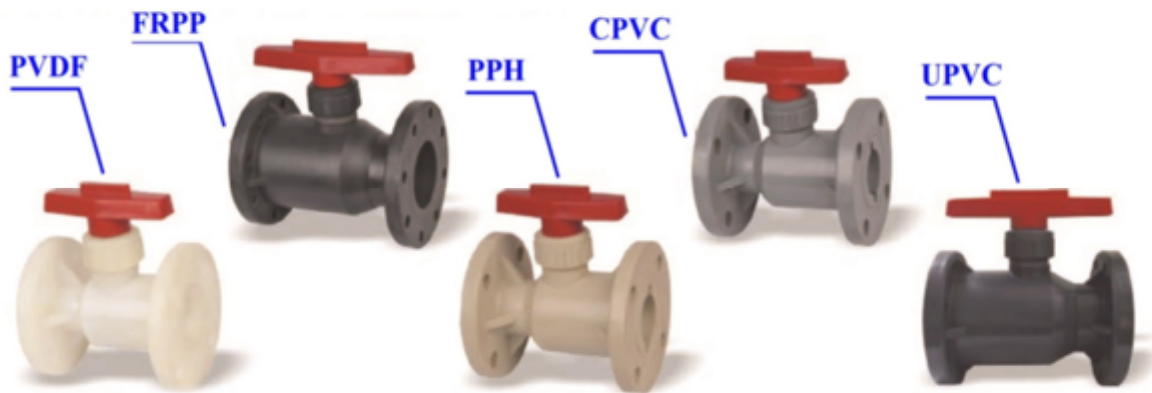

NO.	Name	Material
1	Body	PVDF FRPP PPH CPVC UPVC
2	Ball	PVDF FRPP PPH CPVC UPVC
3	Seal ring	PTFE, F4
4	Inner Plug	PVDF FRPP PPH CPVC UPVC

NO.	Name	Material
5	Hand wheel	ABS
6	Retaining Nut	PVDF FRPP PPH CPVC UPVC
7	Seal	PTFE, F4
8	Stem	PVDF FRPP PPH CPVC UPVC

UNIT: MM

DN	D1	D			L	b	n			Ø		
		JIS	DIN	ANSI			JIS	DIN	ANSI	JIS	DIN	ANSI
15	95	70	65	60	100	14	4	4	4	15	14	16
20	105	75	75	70	120	16	4	4	4	15	14	16
25	115	90	85	80	140	16	4	4	4	19	14	16
32	135	100	100	100	160	16	4	4	4	19	18	16
40	145	105	110	98	165	16	4	4	4	19	18	16
50	160	120	125	120	180	18	4	4	4	19	18	19
65	180	140	145	140	220	22	4	4	4	19	18	19
80	195	150	160	152	250	25	8	8	4	19	18	19
100	215	175	180	190	280	25	8	8	8	19	18	19
125	245	210	210	216	320	30	8	8	8	23	18	22
150	280	240	240	240	360	30	8	8	8	23	23	22
200	335	295	295	298	400	35	12	8	8	23	23	22
250	395	355	350	362	500	38	12	12	12	23	23	22
300	455	400	400	432	600	40	16	12	12	25	23	25

SINGLE UNION CHECK VALVE (UPVC CPVC PPH)

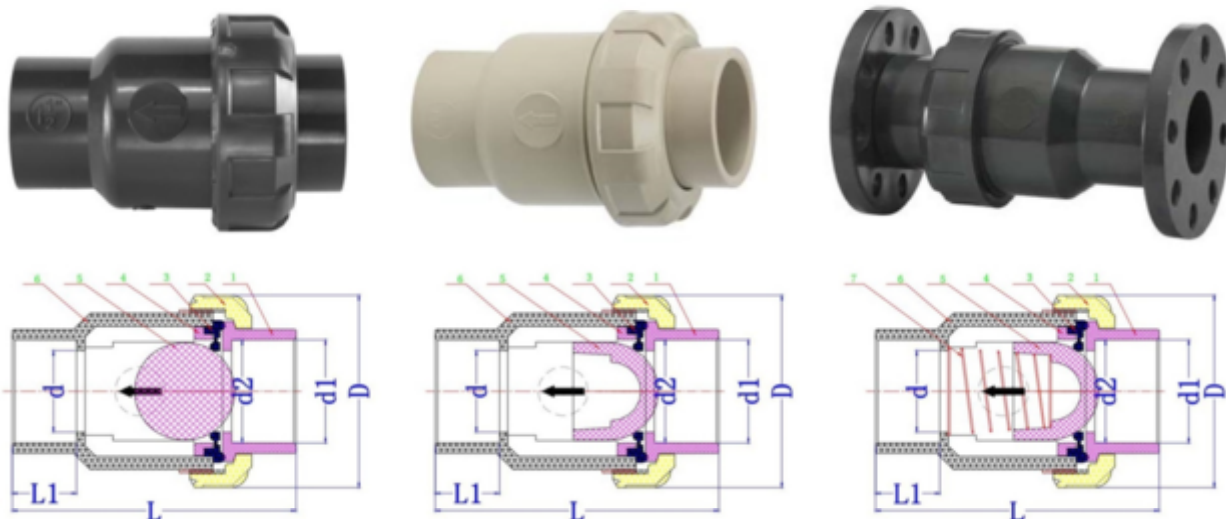

SIZE: 1/2" ~ 3"

JOINT END: SOCKET (ANSI / DIN / JIS)

THREADED (PT/NPT/BSPP)

BALL/HALF BALL

WORKING PRESSURE: 150PSI

No.	Part name	Raw material	QTY	Unit
1	Socket end	UPVC / CPVC / PPH	1	PCS
2	Cap	UPVC / CPVC / PPH	1	PCS
3	Sealing gasket	EPDM / VITON	1	PCS
4	Gasket	UPVC / CPVC / PPH	1	PCS
5	Ball	UPVC / CPVC / PPH	1	PCS
6	Body	UPVC / CPVC / PPH	1	PCS
7	Spring	SUS304	1	PCS

UNIT: MM

SIZE	d	d1				d2				D	L	L1
		ANSI	DIN	JIS	PPH	ANSI	DIN	JIS	PPH			
1/2" (15)	15	21.4	20.3	22.3	19.3	21.3	20.1	21.9	19	54	91	23
3/4" (20)	20	26.7	25.3	26.3	24.1	26.6	25.1	25.9	23.8	63	106.5	26
1" (25)	25	33.5	32.3	32.3	31	33.3	32.1	31.9	30.7	73.5	125	29
1.1/4" (32)	32	42.3	40.3	38.5	39	42.1	40.1	37.9	38.6	84.5	141	33
1.1/2" (40)	40	48.4	50.3	48.5	49	48.2	50.1	47.8	48.6	98	150.5	35.5
2" (50)	50	60.5	63.3	60.6	61.9	60.2	63.1	59.8	61.4	119	169.5	38.5
2.1/2" (65)	63	73.3	75.3	76.6	73.6	72.9	75.1	75.9	72.3	150	245	64.5
3" (80)	75	89.3	90.3	89.6	88.9	88.7	90.1	88.9	86.9	169	270	70
4" (100)	90	114.6	110.4	114.7	108	114.1	110.1	113.9	106.4	211	301	70

TRUE UNION CHECK VALVE (UPVC CPVC PPH)

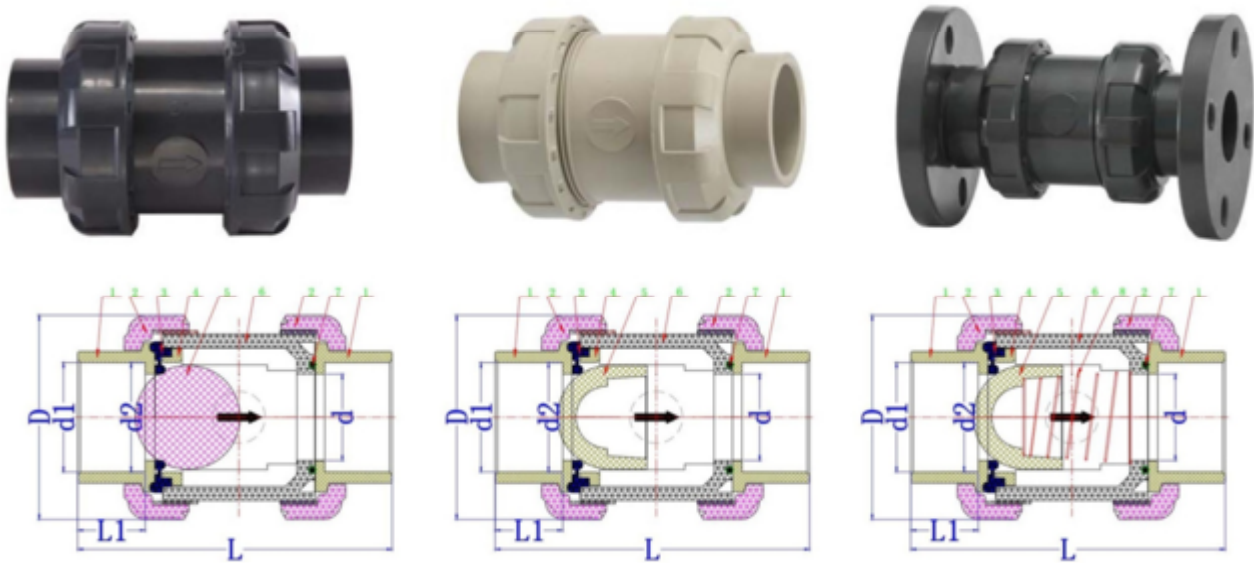

SIZE: 1/2 " ~2 "
JOINT END: SOCKET (ANSI /DIN / JIS)
 THREADED (PT/NPT/BSPF)
 BALL/HALF BALL
WORKING PRESSURE: 150PSI

No.	Part name	Raw material	QTY	Unit
1	Socket end	UPVC / CPVC / PPH	2	PCS
2	Cap	UPVC / CPVC / PPH	2	PCS
3	Sealing gasket	EPDM / VITON	1	PCS
4	Gasket	UPVC / CPVC / PPH	1	PCS
5	Ball	UPVC / CPVC / PPH	1	PCS
6	Body	UPVC / CPVC / PPH	1	PCS
7	O-ring	EPDM / VITON	1	PCS

UNIT: MM

SIZE	d	d1				d2				D	L	L1
		ANSI	DIN	JIS	PPH	ANSI	DIN	JIS	PPH			
1/2" (15)	15	21.4	20.3	22.3	19.3	21.3	20.1	21.9	19	54	91	23
3/4" (20)	20	26.7	25.3	26.3	24.1	26.6	25.1	25.9	23.8	63	106.5	26
1" (25)	25	33.5	32.3	32.3	31	33.3	32.1	31.9	30.7	73.5	125	29
1.1/4" (32)	32	42.3	40.3	38.5	39	42.1	40.1	37.9	38.6	84.5	141	33
1.1/2" (40)	40	48.4	50.3	48.5	49	48.2	50.1	47.8	48.6	98	150.5	35.5
2" (50)	50	60.5	63.3	60.6	61.9	60.2	63.1	59.8	61.4	119	169.5	38.5

FOOT VALVE (II) (UPVC CPVC PPH)

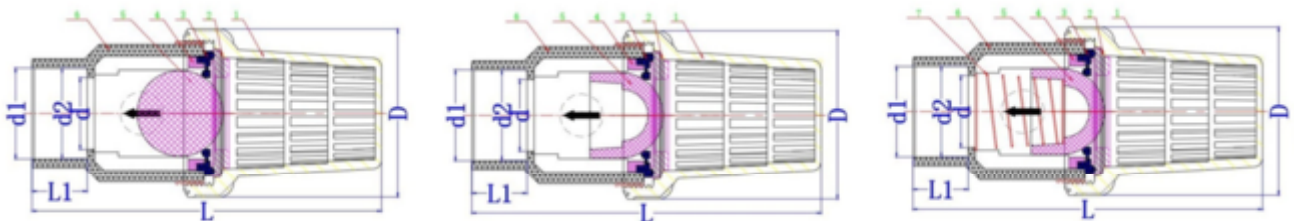

SIZE: 1" ~ 3"

JOINT END: SOCKET (ANSI / DIN / JIS)

THREADED (PT/NPT/BSPP)

BALL/HALF BALL

WORKING PRESSURE: 150PSI

No.	Part name	Raw material	QTY	Unit
1	Socket end	UPVC / CPVC / PPH	1	PCS
2	Cap	UPVC / CPVC / PPH	1	PCS
3	Sealing gasket	EPDM / VITON	1	PCS
4	Gasket	UPVC / CPVC / PPH	1	PCS
5	Ball	UPVC / CPVC / PPH	1	PCS
6	Body	UPVC / CPVC / PPH	1	PCS
7	O-ring	EPDM / VITON	1	PCS

UNIT: MM

SIZE	d	d1				d2				D	L	L1
		ANSI	DIN	JIS	PPH	ANSI	DIN	JIS	PPH			
1/2" (15)	15	21.4	20.3	22.3	19.3	21.3	20.1	21.9	19	54	91	23
3/4" (20)	20	26.7	25.3	26.3	24.1	26.6	25.1	25.9	23.8	63	106.5	26
1" (25)	25	33.5	32.3	32.3	31	33.3	32.1	31.9	30.7	73.5	125	29
1.1/4" (32)	32	42.3	40.3	38.5	39	42.1	40.1	37.9	38.6	84.5	141	33
1.1/2" (40)	40	48.4	50.3	48.5	49	48.2	50.1	47.8	48.6	98	150.5	35.5
2" (50)	50	60.5	63.3	60.6	61.9	60.2	63.1	59.8	61.4	119	169.5	38.5
2.1/2" (65)	63	73.3	75.3	76.6	73.6	72.9	75.1	75.9	72.3	150	295	64.5
3" (80)	75	89.3	90.3	89.6	88.9	88.7	90.1	88.9	86.9	169	335	70
4" (100)	90	114.6	110.4	114.7	108	114.1	110.1	113.9	106.4	211	425	70

UNION (I) (UPVC CPVC PPH)

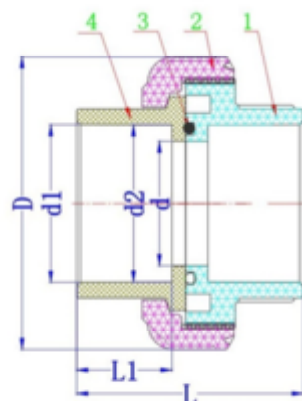

SIZE: 1/2 " ~4 "

JOINT END: SOCKET (ANSI /DIN / JIS/ CNS)

THREADED (PT/NPT/BSPF)

WORKING PRESSURE: 150PSI

No.	Part name	Raw material	QTY	Unit
1	Union Body	UPVC / CPVC / PPH	1	
2	Cap nut	UPVC / CPVC / PPH	1	PCS
3	O-ring	EPDM / VITON	1	PCS
4	Socket end	UPVC / CPVC / PPH	1	PCS

UNIT: MM

SIZE	d	d1				d2				D	L	L1
		ANSI	DIN	JIS	PPH	ANSI	DIN	JIS	PPH			
1/2" (15)	15	21.4	20.3	22.3	19.3	21.3	20.1	21.9	19	54	54	23
3/4" (20)	20	26.7	25.3	26.3	24.1	26.6	25.1	25.9	23.8	63	60.5	26
1" (25)	25	33.5	32.3	32.3	31	33.3	32.1	31.9	30.7	73.5	67.5	29
1.1/4" (32)	32	42.3	40.3	38.5	39	42.1	40.1	37.9	38.6	84.5	77	33
1.1/2" (40)	40	48.4	50.3	48.5	49	48.2	50.1	47.8	48.6	98	83.5	35.5
2" (50)	50	60.5	63.3	60.6	61.9	60.2	63.1	59.8	61.4	119	90.5	38.5
2.1/2" (65)	63	73.3	75.3	76.6	73.6	72.9	75.1	75.9	72.3	150	143	64.5
3" (80)	75	89.3	90.3	89.6	88.9	88.7	90.1	88.9	86.9	169	158	70
4" (100)	90	114.6	110.4	114.7	108	114.1	110.1	113.9	106.4	190	200	84

FLANGE (PPR PPH)

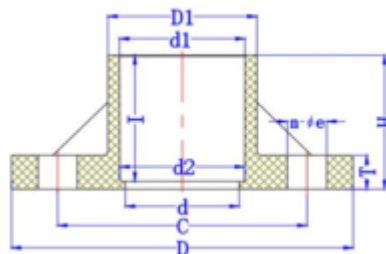

SIZE	D	D1	C		d	d1		d2		H	T	I	n - Ø e	
			DIN	JIS		DIN	JIS	DIN	JIS				DIN	JIS
20	95	32	65	70	15	19.3	22.3	19	21.78	35	14	32	4-15	4-15
25	105	35	75	75	20	24.1	26.3	23.8	25.7	40	15	37	4-15	4-15
32	125	42	85	90	25	31	32.33	30.7	31.67	45	16	40	4-19	4-19
40	140	52	100	100	32	39	38.43	38.6	37.57	49	16	44	4-19	4-19
50	150	62	110	105	43	49	48.46	48.6	47.54	59	18	54	4-19	4-19
63	165	76	125	120	55	61.9	60.56	61.4	59.44	66	20	61	4-19	4-19
75	185	90	145	140	65	73.6	76.88	72.3	75.9	70	22	61	4-19	4-19
90	200	108	160	150	80	88.3	89.67	86.9	88.86	73	22	65	8(4)-19	8(4)-19
110	220	132	180	175	100	108	115	106.4	113.8	93	22	84	8-19	8-19

VAN STONE FLANGE (PPR PPH) DIN

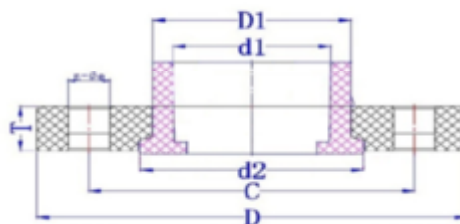
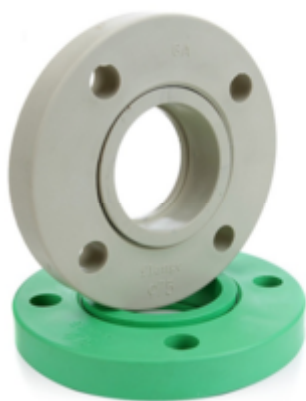

SIZE	D	D1	C	d	d1	d2	H	T	I	n - Ø e
50	140	66	110	45	49	74	35	14	25	4-18
63	155	80	125	58	62	87	35	14	25	4-18
75	175	96	145	71	74	118	40	14	30	4-18
90	185	111	160	85	88	137	44	16	34	8-18
110	210	140	180	105	108	162	47	16	37	8-18
125	248	125	210	120	123	175	120	16	110	8-18
140	248.5	140	210	135	138	185	120	16	110	8-18
160	280	160	240	154	157	210	120	18	110	8-22
200	330	200	295	194	197	230	135	18	120	8-22

FLANGE (UPVC CPVC) DIN

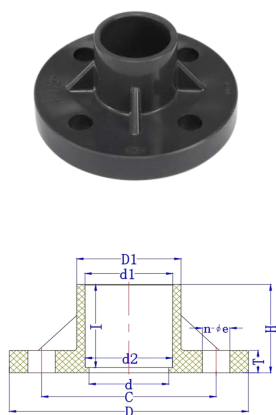

SIZE	D	D1	C	d	d1	d2	H	T	I	n-Ø e
20	95	30.6	65	15	20.3	20.1	24	14	17	4-14
25	105	36	75	20	25.3	25.1	24	14	19	4-14
32	125	43.8	85	25	32.3	32.1	24	14	23	4-14
40	140	52.6	100	32	40.3	40.1	36	17	27	4-18
50	150	60.7	110	40	50.3	50.1	46	17	32	4-18
63	165	74.8	125	51	63.3	63.1	48	17	38	4-18
75	185	89.6	145	63	75.3	75.1	62	19	45	4-18
90	200	106.6	160	77	90.3	90.1	70	19.5	52	8-18
110	220	133	180	102	110.4	110.1	80	19.5	62	8-18
140	250	166	210	135	140.6	139.9	87	20	77	8-18
160	285	187.1	240	156	160.5	160.2	105	22	87	8-22
200	343	237.1	295	194	200.6	200.2	129	25	107	8-22
225	340	215.8	295	220	226.2	225.1	123	32	120	8-22
250	395	293.8	350	246	250.8	250.2	159	31	132	12-22
280	405	313.2	350	275	281.5	280.1	267	31	147	12-22
315	445	344.6	400	310	316	315.2	170	40	165	12-22

VAN STONE FLANGE (UPVC CPVC) DIN

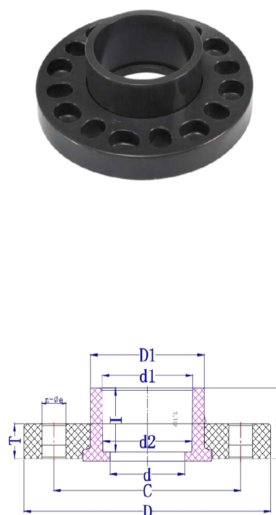

SIZE	D	D1	C	d	d1	d2	H	T	I	n-Ø e
20	95	30.6	65	15	20.3	20.1	26	12	21.6	4-14
25	100	36	75	20	25.3	25.1	29.5	12	23.4	4-14
32	125	43.8	85	25	32.3	32.1	32.2	13	28.7	4-14
40	135	52.6	100	32	40.3	40.1	38.5	13	31.7	4-18
50	140	60.7	110	40	50.3	50.1	40.5	14	32	4-18
63	155	74.8	125	51	63.3	63.1	45.5	15.6	38	4-18
75	175	89.6	145	63	75.3	75.1	51	16	45	4-18
90	185	106.6	160	77	90.3	90.1	55	18	52	8-18
110	210	133	180	102	110.4	110.1	64	20	62	8-18
125	248	151	210	120	125.5	124.9	74	20	70	8-18
140	248.5	166	210	135	140.6	139.9	83	21	77	8-18
160	280	187.1	240	156	160.5	160.2	91	26	87	8-22
180	280	201.8	240	175	180.6	180.2	95	28	95	8-22
200	330	237.1	295	194	200.6	200.2	116	30	107	8-22
225	340	215.8	295	220	226.2	225.1	123	32	120	8-22
250	400	293.8	350	246	250.8	250.2	140	34	132	12-22
280	405	313.2	350	275	281.5	280.1	162	35	147	12-22
315	445	344.6	400	310	316	315.2	170	40	165	12-22
355	510	398	460	350	356.6	355.1	193	40	185	12-22
400	570	447.4	515	395	401.6	400.1	200	44	208	16-26
450	620	493	565	445	452	450.1	245	45	233	20-26
500	670	547.8	620	495	502.8	500.1	268	50	256	20-26

FLANGE (UPVC CPVC) ANSI

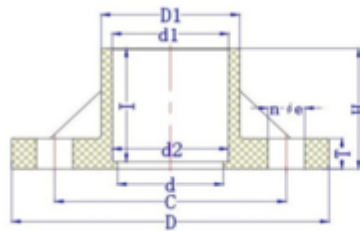

SIZE	D	D1	C	d	d1	d2	H	T	I	n-Ø e
1/2" (15)	89	32	61	15	21.54	21.25	35	14	24	4-14
3/4" (20)	99	35	70	20	26.87	26.58	40	14	27	4-14
1" (25)	108	43	79	25	33.65	33.28	45	14	30	4-14
1.1/4" (32)	117	52	89	32	42.42	42.05	49	16	34	4-18
1.1/2" (40)	127	59	98	43	48.56	48.12	59	16	37	4-18
2" (50)	152	75	121	55	60.63	60.18	66	16	38	4-18
2.1/2" (65)	178	89	140	65	73.38	72.85	70	19	46	4-18
3" (80)	191	106	152	80	89.31	88.7	73	20	50	8-18
4" (100)	229	132	191	100	114.76	114.1	75	20	57	8-18
5" (125)	254	167	216	136	141.81	141	83	20	66	8-18
6" (150)	279	187	241	150	165.98	168	120	25	69	8-22
8" (200)	343	243	298	204	219.84	218.7	130	25	79	8-22
10" (250)	406.4	308	362	256	273.81	272.67	151	31	102	12-25
12" (300)	480	343	432	296	324.61	323.47	170	34	155	12-25

VAN STONE FLANGE (UPVC CPVC) ANSI

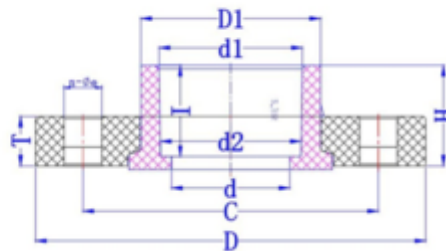

SIZE	D	D1	C	d	d1	d2	H	T	I	n-Ø e
1/2" (15)	89	32	61	15	21.54	21.25	35	14	21	4-14
3/4" (20)	99	35	70	20	26.87	26.58	40	15	23	4-14
1" (25)	108	43	79	25	33.65	33.28	45	16	28	4-14
1.1/4" (32)	117	52	89	32	42.42	42.05	49	16	31	4-18
1.1/2" (40)	127	59	98	43	48.56	48.12	59	18	35	4-18
2" (50)	152	75	121	55	60.63	60.18	66	20	38	4-18
2.1/2" (65)	178	89	140	65	73.38	72.85	70	24	45	4-18
3" (80)	191	106	152	80	89.31	88.7	73	26	48	8-18
4" (100)	229	132	191	100	114.76	114.1	75	28	57	8-18
6" (150)	279	187	241	150	165.98	168	120	32	75	8-22
8" (200)	343	243	298	204	219.84	218.7	130	35	104	8-22
10" (250)	406.4	308	362	256	273.81	272.67	151	42	128	12-25
12" (300)	480	343	432	296	324.61	323.47	170	52	172	12-25

FLANGE (UPVC CPVC) JIS

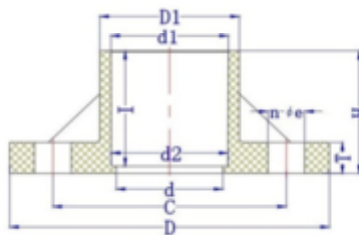

SIZE	D	D1	C	d	d1	d2	H	T	I	n-Ø e
15A	95	32	70	15	22.4	21.5	26	14	22	4-15
20A	105	35	75	20	26.5	25.4	29	15	23	4-15
25A	125	43	90	25	32.5	31.4	32	16	28	4-19
32A	140	52	100	32	38.4	37.3	38	16	31	4-18
40A	150	59	105	43	48.7	47.2	40	18	35	4-18
50A	165	72	120	55	60.8	59.1	45	20	38	4-18
65A	185	89	140	65	76.6	75.3	51	22	45	4-18
80A	200	106	150	80	89.6	88.3	55	22	48	8-19
100A	220	132	175	100	114.7	113.2	64	25	57	8-19
125A	250	160	210	125	140.8	140.2	80	28	67	8-19
150A	285	187	240	150	166	164.7	87	32	76	8-23
200A	330	237	295	200	217	215.5	116	35	104	12-23
250A	395	294	355	250	268	266.3	150	42	128	12-25

VAN STONE FLANGE (UPVC CPVC) JIS

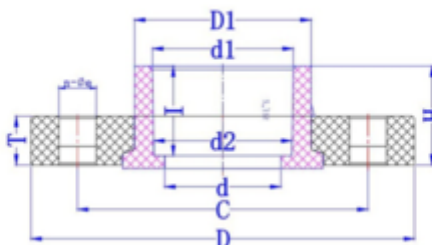

SIZE	D	D1	C	d	d1	d2	H	T	I	n-Ø e
15A	95	30.6	70	15	22.4	21.5	26	14	22	4-15
20A	100	36	75	20	26.5	25.4	29	15	23	4-15
25A	125	43.8	90	25	32.5	31.7	32	16	28	4-19
32A	135	52.6	100	32	38.6	37.3	38	16	32	4-19
40A	140	60.7	105	40	48.7	47.2	40	18	35	4-19
50A	155	74.8	120	51	60.8	59.1	45	20	38	4-19
65A	175	89.6	140	63	76.6	75.3	51	24	45	4-19
80A	185	106.5	150	77	89.6	88.3	55	26	48	8-19
100A	210	133	175	102	114.7	113.2	64	28	57	8-19
125A	250	160.1	210	125	140.8	140.2	80	28	67	8-23
150A	280	187.1	240	156	166	164.7	87	32	76	8-23
200A	330	237.1	295	204	217	215.5	116	35	104	12-23
250A	400	293.8	355	256	268	266.3	150	42	128	12-25
300A	445	344.6	400	307	319	317.3	190	52	172	16-25

BUTTERFLY VALVE (LEVER HANDLE) UPVC CPVC PPH

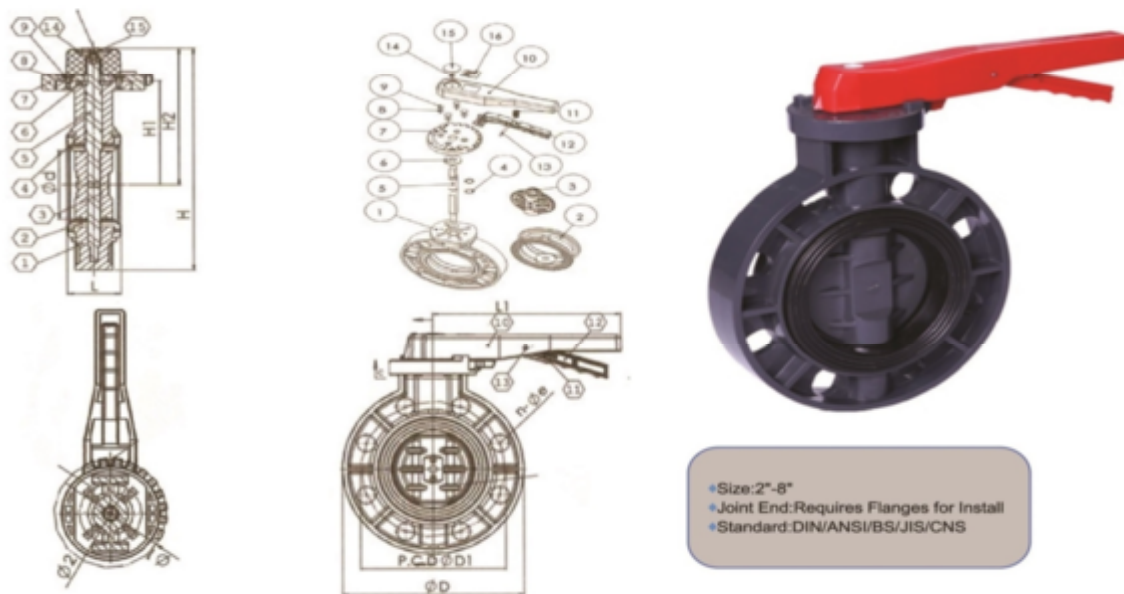

Specification of Material

NO.	Part	Material	QTY
1	Body	UPVC/CPVC/PPH	1
2	Seat Seal	EPDM/FPM	1
3	Disc	UPVC/CPVC/PPH	1
4	O-Ring	EPDM/FPM	2
5	Stem	Steel/SS304/SS316	1
6	Baffle	ABS	1
7	Plate	ABS	1
8	Screw	Steel	2

NO.	Part	Material	QTY
9	Caps	ABS	2
10	Handle	ABS	1
11	Spring	304	1
12	Lever	ABS	1
13	Set-Pin	STEEL	1
14	Bolt	STEEL	1
15	Mark Cap	ABS	1
16	Logo Plate	ABS	1

Dimensions

Unit: mm

Size	Inch	2"	2.1/2"	3"	4"	5"	6"	8"
	DN	50	65	80	100	125	150	200
ØD		160	180	196	228	258	287	344
P.C.D. ØD1	DIN	125	145	160	180	210	240	295
	JIS	121	140	152	191	216	241	298
	ANSI	120	140	150	175	210	240	290
Ød		48	63	78	98	122	146	199
L		43	46	49	54	64	70	88
Ø1		124	124	124	124	170	170	170
L1		190	190	240	240	310	310	310
W		55	55	55	55	72	72	72
H1		100	112	120	140	168	181	215
H2		143	155	172	194	223	239	280
H		223	245	270	308	352	382	452
n- Øe	DIN	4-19	419	8-19	8-19	8-19	8-23	8-23
	ANSI	4-19	4-19	8-19	8-19	8-19	8-23	8-23
	JIS	4-19	4-19	8-19	8-19	8-19	8-23	8-23
Pressure	PSI	150	150	150	150	150	150	120
	Mpa	1	1	1	1	1	1	0.8

BUTTERFLY VALVE (GEAR TYPE HANDLE) UPVC CPVC PPH

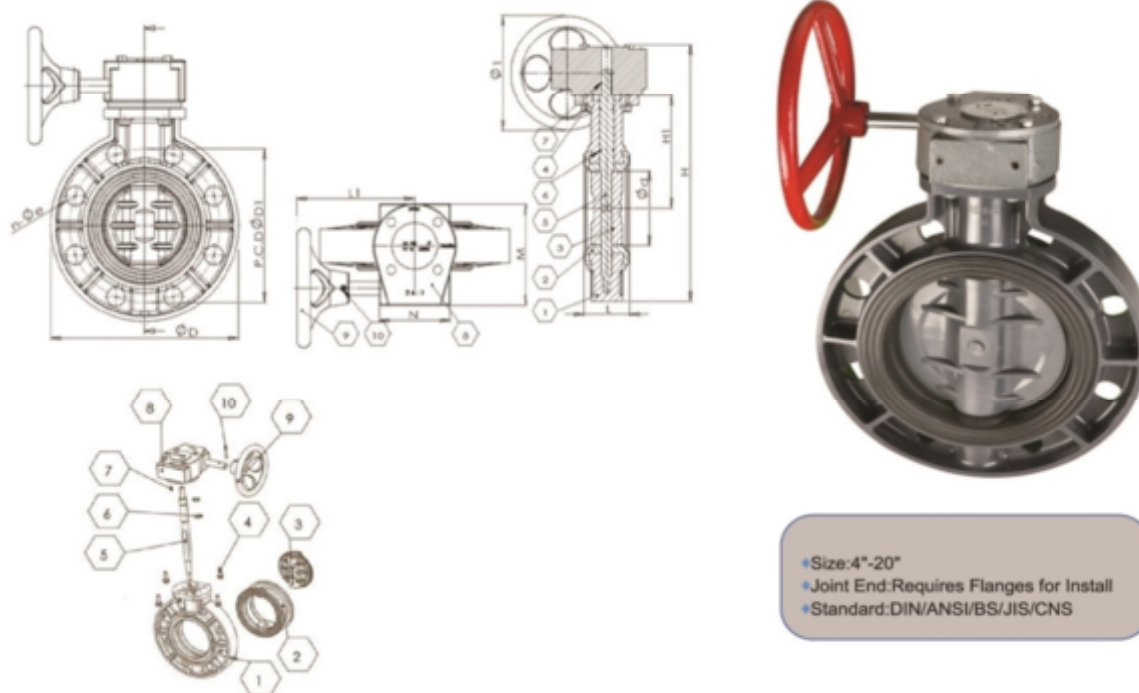

Specification of Material

NO.	Part	Material	QTY
1	Body	UPVC/CPVC/PPH	1
2	Seat Seal	EPDM/FPM	1
3	Disc	UPVC/CPVC/PPH	1
4	Bolt	SS304	2
5	Stem	Steel/SS304/SS316	1

NO.	Part	Material	QTY
6	O-Ring	EPDM/FPM	1
7	Key	Steel	1
8	Gear-box	Iron	2
9	Handle Wheel	Iron	2
10	Pin	Steel	1

Dimensions

Unit: mm

Size	Inch	4"	5"	6"	8"	10"	12"	14"	16"	20"
	DN	100	125	150	200	250	300	350	400	500
ØD		228	258	287	344	412	460	500	565	670
P.C.D. ØD1	DIN	180	210	240	295	350	400	460	515	620
	JIS	190	216	241	298	362	432	476	540	540
	ANSI	175	210	240	290	355	400	445	510	510
Ød		98	122	146	199	255	302	345	395	490
L		54	64	70	88	98	108	88	98	135
ØI		145	280	280	280	280	280	380	380	280
L1		120	200	200	200	220	220	280	280	280
H1		140	168	181	215	260	280	410	490	520
H		340	385	417	487	551	595	670	770	865
M		120	180	180	180	180	180	250	250	250
N		90	100	100	100	130	130	220	220	220
n- Øe	DIN	8-19	8-19	8-23	8-23	12-25	12-25	16-25	16-27	20-23
	ANSI	8-19	8-19	8-23	8-23	12-25	12-25	12-29	16-29	20-32
	JIS	8-19	8-19	8-23	12-23	12-25	16-25	16-25	16-27	20-32
Pressure	PSI	150	150	150	150	120	120	100	100	100
	Mpa	1	1	1	1	0.8	0.8	0.6	0.6	0.6

SWING TYPE CHECK VALVE (UPVC CPVC)

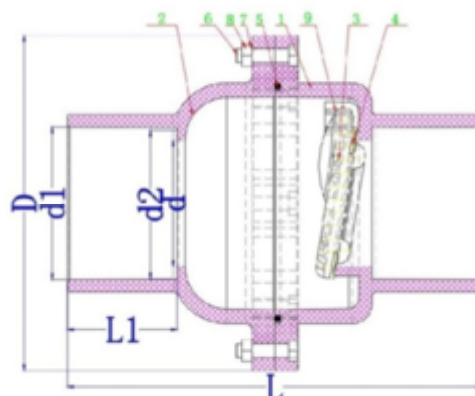

SIZE: 3/4" – 8"

JOINT END: SOCKET (ANSI / DIN / JIS / CNS)

WORKING PRESSURE: 150 PSI

No.	Part name	Raw materiel	QTY	Unit
1	Upper body	UPVC / CPVC	1	PCS
2	Bottom body	UPVC / CPVC	1	PCS
3	Valve plate	UPVC / CPVC	1	PCS
4	Sealing gasket	EPDM / VITON	1	PCS
5	O-ring	EPDM / VITON	1	PCS
6	Bolt	STEEL / SS304	(4-12)	PCS
7	Bolt gasket	STEEL / SS304	(4-12)	PCS
8	Nut	STEEL / SS304	(4-12)	PCS
9	Tooth buckle	UPVC / CPVC	2	PCS

UNIT: MM

SIZE	d	d1			d2			D	L	L1
		ANSI	DIN	JIS	ANSI	DIN	JIS			
3/4" (20)	22	26.9	25.3	26.5	26.6	24.9	26.1	58	101	22
1" (25)	28	33.7	32.3	32.6	33.3	31.9	32.2	68	126	25
1.1/4" (32)	36	42.4	40.3	38.6	42.1	39.9	38.3	78	145	30
1.1/2" (40)	43	48.6	50.3	48.7	48.1	49.9	48.2	88	162	36
2" (50)	55	60.6	63.3	60.8	60.2	62.9	60.3	95	174	45
2.1/2" (65)	63	73.38	75.3	76.6	72.85	75.1	75.87	168	212	50
3" (80)	75	89.31	90.4	89.6	88.7	90.1	88.83	172	230	53
4" (100)	95	114.76	110.4	114.7	114.1	110.1	113.8	205	274	62
5" (125)	125	141.81	140.5	140.8	141.1	140.2	140.1	260	372	70
6" (150)	150	168.83	160.5	166.2	168.1	160.1	164.7	290	390	90
8" (200)	190	219.84	200.6	217	218.7	200.2	215.5	380	460	120



FOOT VALVE (I) (UPVC CPVC)

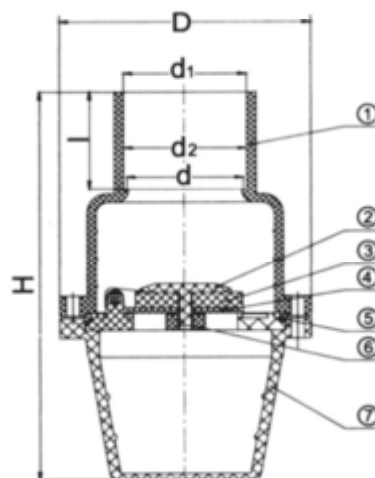

SIZE: 2.1/2'' – 8''

JOINT END: SOCKET (ANSI / DIN / JIS / CNS)

WORKING PRESSURE: 150 PSI

No.	Part name	Raw meterial	Qty	Unit
1	Upper body	UPVC / CPVC	1	PCS
2	Valve plate	UPVC / CPVC	1	PCS
3	Tooth buckle	UPVC / CPVC	2	PCS
4	O-ring	NBR/EPDM	1	PCS
5	Bolt, Nut & Bolt gasket	STEEL / SS304	(8-12)	PCS
6	Sealing gasket	EPDM / VITON	1	PCS
7	Bottom body	UPVC / CPVC	1	PCS

UNIT: MM

SIZE	d	d1			d2			D	H	I
		ANSI	DIN	JIS	ANSI	DIN	JIS			
2.1/2" (65)	63	73.38	75.3	76.6	72.85	75.1	75.87	168	212	50
3" (80)	75	89.31	90.4	89.6	88.7	90.1	88.83	172	230	53
4" (100)	95	114.76	110.4	114.7	114.1	110.1	113.8	205	274	62
5" (125)	125	141.81	140.5	140.8	141.1	140.2	140.1	260	372	70
6" (150)	150	168.83	160.5	166.2	168.1	160.1	164.7	290	390	90
8" (200)	190	219.84	200.6	217	218.7	200.2	215.5	380	460	120

FOOT VALVE （ I ） （UPVC CPVC）

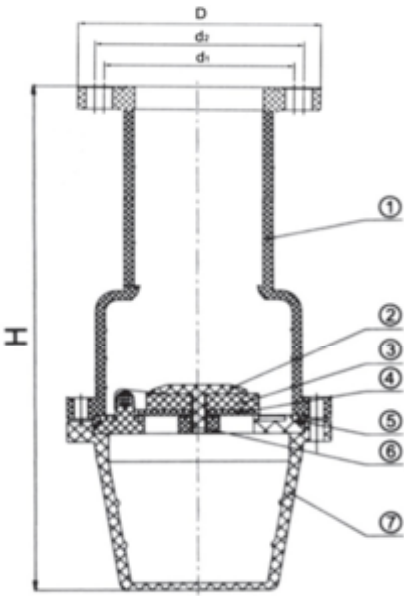

SIZE: 2.1/2’’ – 8’’

JOINT END: FLANGE (ANSI / DIN / JIS / CNS)

WORKING PRESSURE: 150 PSI

No.	Part name	Raw material	Qty	Unit
1	Upper body	UPVC / CPVC	1	PCS
2	Valve plate	UPVC / CPVC	1	PCS
3	Tooth buckle	UPVC / CPVC	2	PCS
4	O-ring	NBR/EPDM	1	PCS
5	Bolt, Nut & Bolt gasket	STEEL / SS304	(8-12)	PCS
6	Sealing gasket	EPDM / VITON	1	PCS
7	Bottom body	UPVC / CPVC	1	PCS

UNIT: MM

SIZE	D	d1	d2	H	n-Ø e
2.1/2" (65)	185	130	145	270	4-18
3" (80)	195	150	160	293	8-18
4" (100)	225	180	180	359	8-18
5" (125)	255	200	220	474	8-18
6" (150)	285	240	240	501	8-22
8" (200)	338	295	295	601	8-22

WAPER CHECK VALVE (UPVC CPVC)

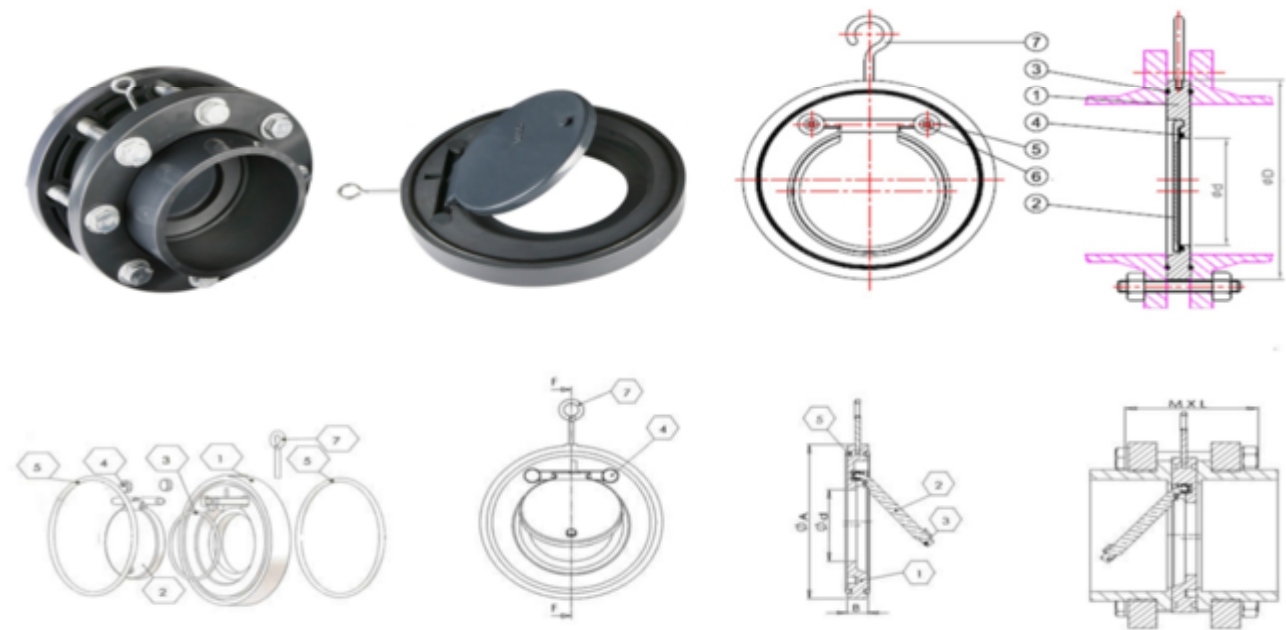

SIZE: 2'' – 12''

JOINT END: FLANGE (ANSI / DIN / JIS / CNS)

WORKING PRESSURE: 150 PSI

No.	Part name	Raw material	QTY	Unit
1	Body	UPVC / CPVC	1	PCS
2	Flaper	UPVC / CPVC	1	PCS
3	Body Seal	EPDM / VITON	1	PCS
4	Seat	EPDM / VITON	1	PCS
5	Gasket	EPDM / VITON	2	PCS
6	Tooth buckle	UPVC / CPVC	2	PCS
7	O-Bolt	STEEL / SS304	1	PCS

UNIT: MM

D	DN	Inch	ØD (mm)	Ød (mm)	L (mm)
60	50	2''	110	30	20
75	65	2.1/2''	120	40	20
90	80	3''	140	47	23
110	100	4''	160	62	23
140	125	5''	192	83	24
160	150	6''	218	105	26
225	200	8''	273	140	34
250	250	10''	328	170	40
315	300	12''	380	220	45



PPR DOUBLE UNION BRASS BALL VALVE

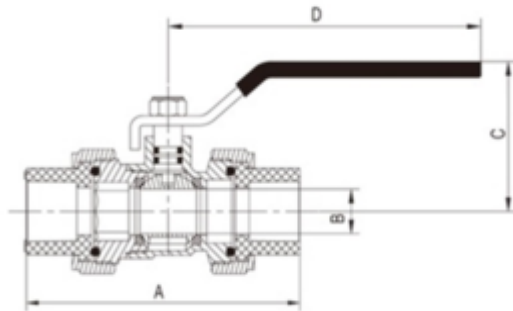

Name of Part	Material
Body and cap	Brass, Brass nickel plated, SS304
Connect fitting	PPR
Ball	Brass, Brass chrome plated, SS304
Ball seat and packing	PTFE
Stem and gland	Brass
Handle	Steel chrome plated with PVC coating

UNIT: MM

D	20	25	32	40	50	63	75	90	110
Size	1/2"	3/4"	1"	1.1/4"	1.1/2"	2"	2.1/2"	3"	4"
A	90	100	115	133	151	170	178	208	253
B	15	19	24	29	37	47	47	62	75
C	54	49	58	63	71	95	95	122	145
D	95	95	110	110	150	165	165	224	246

PPR STOP VALVE

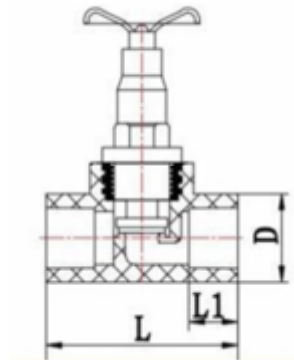

UNIT: MM

D	20	25	32	40	50	63	75	90	110
Size	1/2"	3/4"	1"	1.1/4"	1.1/2"	2"	2.1/2"	3"	4"
L	70	83	86	97	121	133	167	201	245
L1	16	18	20	22	25	28	32	36	42
D	29	36	43	55	70	87	103	123	149

PHỤ KIỆN HDPE HÀN ĐỐI ĐẦU



PHỤ KIỆN HDPE HÀN ĐIỆN TRỞ



PHỤ KIỆN HDPE NỐI NHANH



VAN CÔNG MẶT BÍCH



VAN NHỰA UPVC



VAN NHỰA PPR / PPH



MÔI NỐI MỀM



PHỤ KIỆN GANG



CÔNG TY TNHH THƯƠNG MẠI VÀ ĐẦU TƯ XÂY DỰNG BẢO HÀ

Địa chỉ : Số 22A, Ngõ 42, Phố Yên Hòa, Phường Yên Hòa, Quận Cầu Giấy, Hà Nội, Việt Nam

Mobile : 0977 931 525

Email : baohatic@gmail.com

Website : baohatic.vn